

8 WEDGE®

INSTRUCTIONAL SHEET



Developed by
Firefighters for
Firefighters

- 1 Drive the **8 WEDGE®** into the frame using a striking tool (Halligan, The Pig®, Axe) to make a gap. (Fig. 1)
- 2 When your **8 WEDGE®** contacts the jamb, STOP and remove.
- 3 Exploit the gap with your tool, using your **8 WEDGE®** to hold your gains. (Fig. 3)
- 4 Once door is crushed beyond the jamb, drive the **8 WEDGE®** into the gap to make a wider opening. Finish forcing with Halligan. (Fig. 4)

INWARD SWINGING DOOR

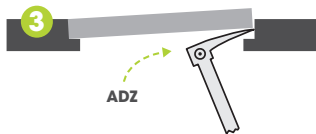

OUTWARD SWINGING DOOR

